

# Taking the ALEKS Assessment

## Tip for taking the ALEKS:

- It is important the ALEKS Assessment is taken seriously **without the use of a calculator or other technology** and without help from other individuals.
- Each student should give their best effort on the assessment so their score truly reflects their **current level of math preparedness**.
- There is no benefit to cheating on the assessment** or consulting outside sources. The purpose is to measure a student's current mathematical knowledge so that they will be successful in their first mathematics course.
- Make sure to **submit** your assessment **before the end of your 2 hour time limit**. This will register your score in the system and generate your individualized learning modules.

**Step 1:** Access the ALEKS assessment through your CU Denver UCD Access student portal <https://passport.ucdenver.edu/login.php>.

The screenshot shows the CU Denver UCD Access student portal dashboard. The top navigation bar includes the CU Denver logo, the name 'Denver | Anschutz', a search bar, and utility icons. The main content area is divided into several sections:

- Student Center:** A grid of icons for Academics, Admissions, Advisor, Class Search, Student Account, Financial Aid, Register for Classes (add/drop), Profile, Tasks - Holds, and Tasks - To-Do Items.
- Student Schedule:** A calendar view for Spring 2024 showing classes for Monday, Wednesday, and Thursday. The Thursday column is highlighted in blue. The schedule shows CSCI 5575 NRTH 3202 Hybrid Enrolled on Monday and Wednesday.
- Quick Links:** A vertical list of buttons for Canvas, WebMail, Degree Audit, CU Denver Calendars, and Campus Closures.
- Student Resources:** A vertical list of buttons for CU Denver Handshake, **ALEKS Math Placement** (highlighted with a red box and a red arrow), LinkedIn Learning, and Start Skillsoft.
- Apply for Scholarships:** A button with a ribbon icon.
- CU Resources:** A button with the CU Denver logo.

**Step 2:**

If this is your first time setting up an ALEKS account please select No, I have never used ALEKS before.

If you have already used ALEKS please select Yes, and use your original credentials. You may disregard steps 3 and 4 if they do not apply to you

ALEKS

## Welcome to ALEKS!

Have you used ALEKS before?

No, I have never used ALEKS before.

Yes, I have an ALEKS login name.

**Log Into Account**

ALEKS Login Name:

Password:

[I forgot my login information >](#)

**Step 3:** Read and accept the Terms of Use and then hit continue.

## User Agreement

Review and Accept Terms of Use

I agree to the [Terms of Use](#)

#### Step 4:

You should see the confirmation below. Please hit continue at the bottom of the screen.

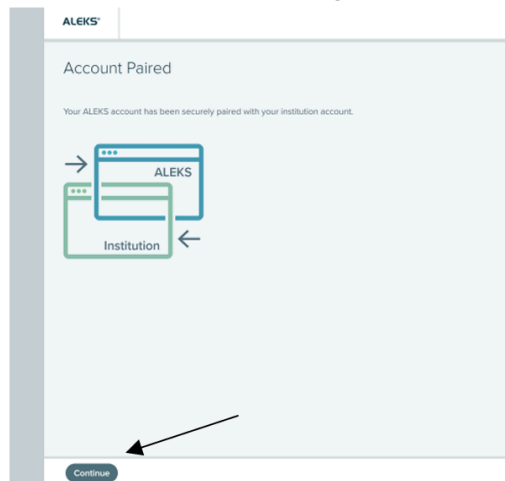

**Step 5:** You are now in the ALEKS Placement Portal. To start your assessment click where it says “Enter your class here.”

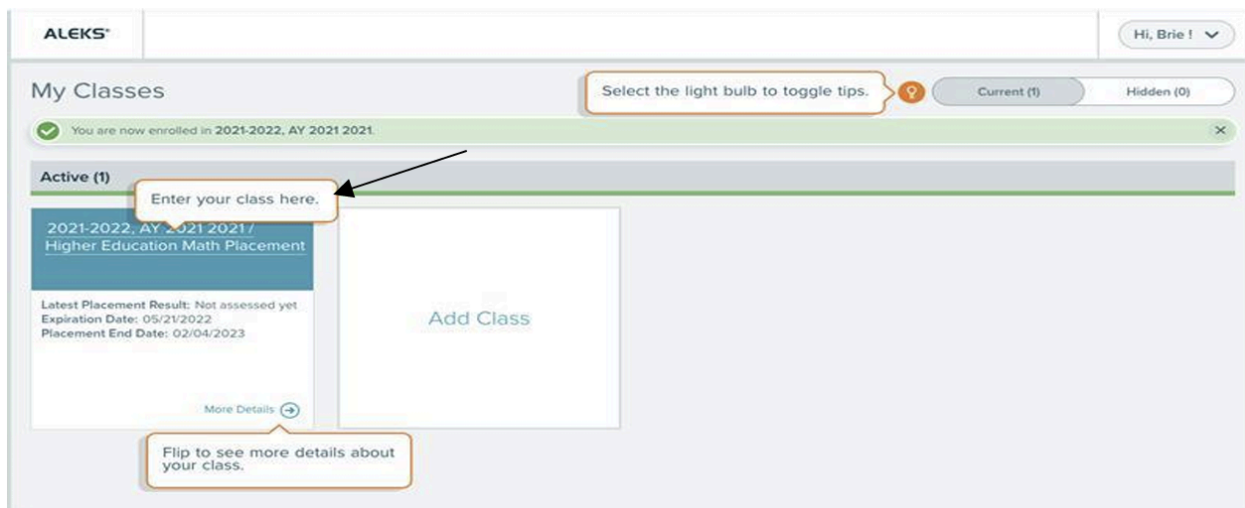

**IMPORTANT:** Each student will have one account that expires *1 year after set-up*. If you have not taken your first assessment in this time period contact [math.placement@ucdenver.edu](mailto:math.placement@ucdenver.edu) to reset your account..

#### Step 6:

Once you have completed your first assessment you will be assigned learning modules based on your proficiency in each Sub topic. Please complete 5 hours of modules to unlock your second attempt, and 3 hours for each subsequent attempt. Progress towards completion can be found on the left hand side of the main assessment page.